

THIS DRAWING AND THE DATA DISCLOSED HEREIN OR HEREWITH IS NOT TO BE REPRODUCED USED OR DISCLOSED IN WHOLE OR IN PART TO ANYONE WITHOUT THE PERMISSION OF JESS-LINK PRODUCTS CO.,LTD.

CUSTOMER DRAWING

REV.	DESCRIPTION	MDF'D	APP'D	DATE
02	ADD JPC LOGO	Brown	Matsu	02/17/2014
03	ADD RECOMMENDED PRINTED CIRCUIT BOARD	Brown	Matsu	03/24/2014
04	MODIFY DRAWING	Brown	Matsu	07/01/2015

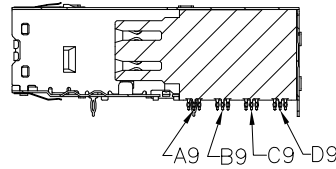
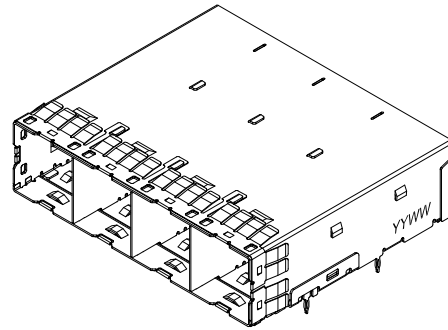
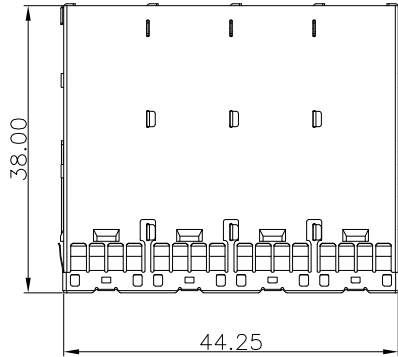

SECTION Z-Z

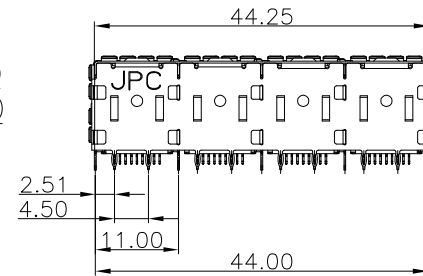
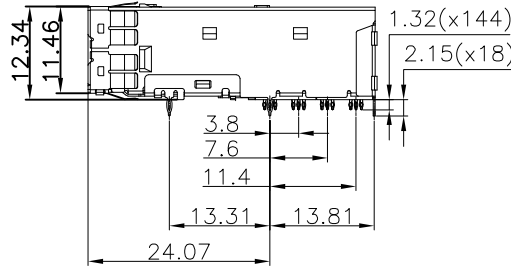
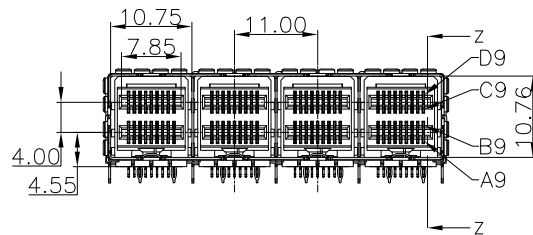

NOTE:

- MATERIAL: FINISH  
HOUSING: HI-TEMP THERMOPLASTIC UL 94V-0 BLACK  
TERMINAL : COPPER ALLOY/ PLATING SEE P/N MARTAX  
EMI CAGE : COPPER SILVER ALLOY/PREPLATING Ni  
EMI SPRING : COPPER ALLOY/PREPLATING Ni
- DATE CODE: YYWW  
YY=YEAR OF MANUFACTURE  
WW=WEEK OF MANUFACTURE
- PACKAGE: TRAY
- MOUNTING HARDWARE: M2X0.4 BUTTON HEAD SCREW  
MOUNTING SCREW LENGTH: BOARD THICKNESS +(0.9~1.4mm Max).  
THE CONNECTOR HOLD DOWN SCREW SHOULD BE TORQUED TO 2kgf/cm MAX.DO NOT OVER TORQUE.
- OPTIONAL PARTS: JPC P/N  
SINGLE PORT LIGHT PIPE: P9214YLS SERIES  
DUAL PORT LIGHT PIPE: P9214YLD SERIES
- P/N: MARTAX:

JPC P/N: P 9 2 1 4 C 0 3 0 0 0 T - 0

- SFF 8644 EXTERNAL HD COMBO TYPE CONNECTOR
- TYPE SERIES:  
1: SINGLE PORT SERIES  
2: 1X2 PORT SERIES  
4: 1X4 PORT SERIES
- CAGE TYPE:  
A: STANDARD  
B: SUPPORT HEAT SINK  
C: STANDARD W/STOPS  
D: SUPPORT HEAT SINK W/STOPS
- KEY:  
0: STANDARD KEY
- CONNECTOR PLATING:  
2:15u' Au ON CONTACT AREA+ G/F TAIL  
3:30u' Au ON CONTACT AREA+ G/F TAIL
- T : TRAY
- MOUNTING SCREW  
0: SHIP W/o SCREW
- LIGHT PIPE OPTIONAL:  
0 : W/o LIGHT PIPE  
1 : SINGLE PORT LIGHT PIPE CLEAR  
2 : DUAL PORT LIGHT PIPE CLEAR
- HEAT SINK OPTIONAL:  
0 : NON-HEAT SINK

ROHS COMPLIANT HALOGEN FREE	Unit : mm	PROJECTION		<b>JESS-LINK PRODUCTS CO.,LTD.</b>		PRODUCT NO. OR LAYOUT
	GENERAL TOLERANCES: (UNLESS SPECIFIED)	D.R. 08/28/2012				
	0 = ±.45 0.0 = ±.30 0.00 = ±.20 0.000 = ±.10 0" = ±.2" 0.0" = ±.1"	Brown	TITLE		SFF 8644 EXTERNAL HD COMBO TYPE	
		James	CONNECTOR(STANDARD W/STOPS 1X4 PORT)		REV. 04	
	APV.D 08/28/2012	Matsu	SCALE	SIZE	PART NO.	SH,T NO.1 OF 11
			1:1	A4	P9214C03000T-0	

THIS DRAWING AND THE DATA DISCLOSED HEREIN OR HEREWITH IS NOT TO BE REPRODUCED USED OR DISCLOSED IN WHOLE OR IN PART TO ANYONE WITHOUT THE PERMISSION OF JESS-LINK PRODUCTS CO.,LTD.

CUSTOMER DRAWING

REV.	DESCRIPTION	MDF'D	APP'D	DATE
02	ADD JPC LOGO	Brown	Matsu	02/17/2014
03	ADD RECOMMENDED PRINTED CIRCUIT BOARD	Brown	Matsu	03/24/2014
04	MODIFY DRAWING	Brown	Matsu	07/01/2015



PCI ADD-IN CARD APPLICATION

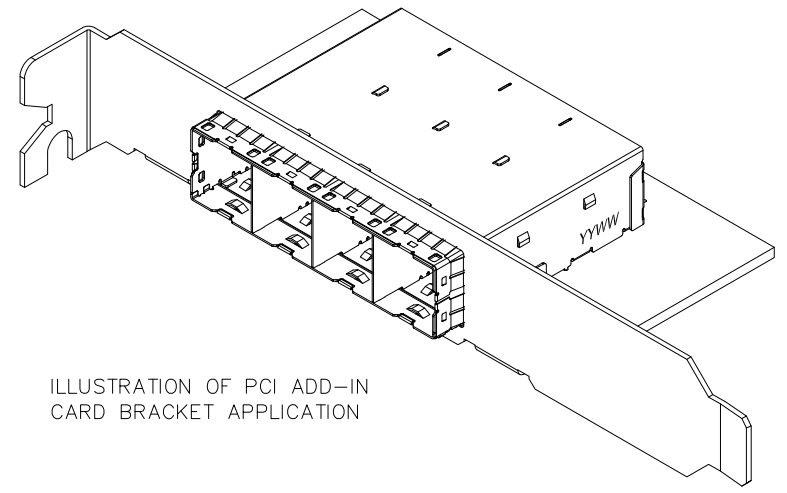
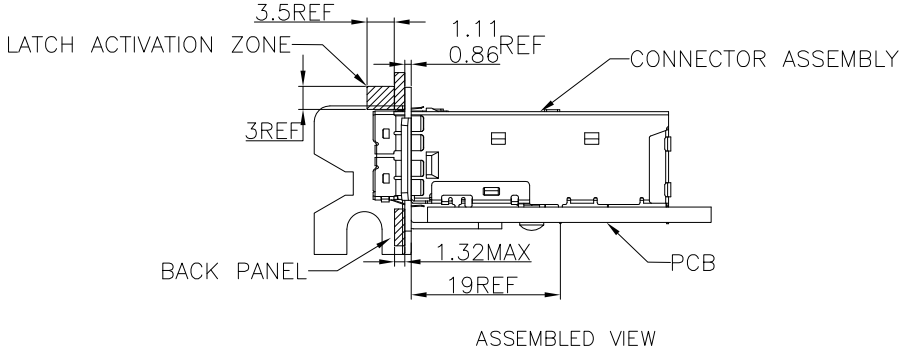
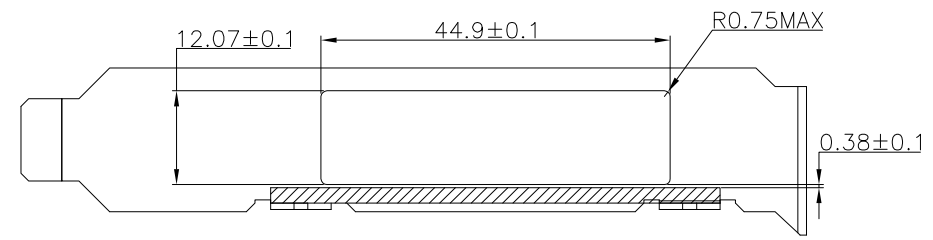
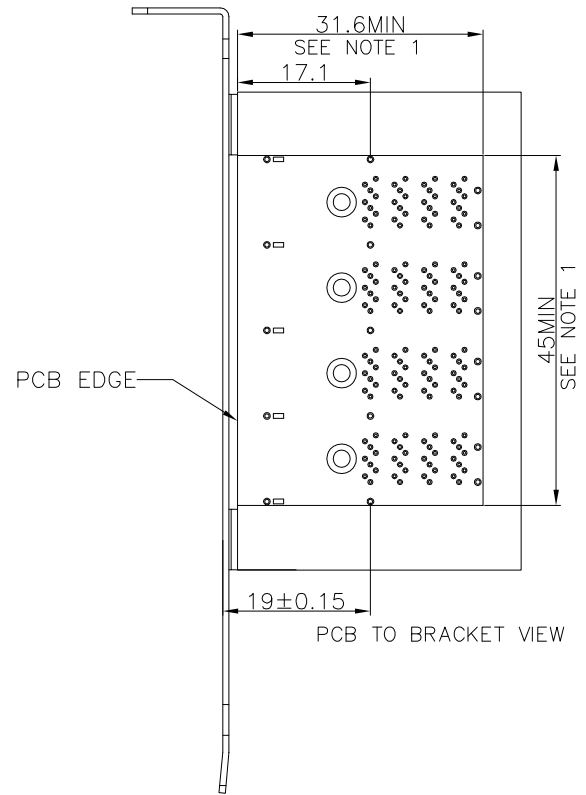

ILLUSTRATION OF PCI ADD-IN CARD BRACKET APPLICATION



I/O BRACKET CUT OUT (BRACKET NOT SUPPLIED)

NOTE:  
1. CONNECTOR KEEP OUT AREA

<b>ROHS COMPLIANT</b>	<b>HALOGEN FREE</b>	Unit : mm	PROJECTION		<b>JESS-LINK PRODUCTS CO.,LTD.</b>		TITLE SFF 8644 EXTERNAL HD COMBO TYPE CONNECTOR(STANDARD W/STOPS 1X4 PORT)	PRODUCT NO. OR LAYOUT	
		GENERAL TOLERANCES: (UNLESS SPECIFIED)		D.R. 08/28/2012					James
		0 = ±.45	0.0 = ±.30	CH.K 08/28/2012	James	SCALE	SIZE	PART NO.	REV. 04
		0.000 = ±.20	0° = ±.10	APV.D 08/28/2012	Matsu	1:1	A4	P9214C03000T-0	SH,T NO.2 OF 11

THIS DRAWING AND THE DATA DISCLOSED HEREIN OR HEREWITH IS NOT TO BE REPRODUCED USED OR DISCLOSED IN WHOLE OR IN PART TO ANYONE WITHOUT THE PERMISSION OF JESS-LINK PRODUCTS CO.,LTD.

CUSTOMER DRAWING

REV.	DESCRIPTION	MDF'D	APP'D	DATE
02	ADD JPC LOGO	Brown	Matsu	02/17/2014
03	ADD RECOMMENDED PRINTED CIRCUIT BOARD	Brown	Matsu	03/24/2014
04	MODIFY DRAWING	Brown	Matsu	07/01/2015

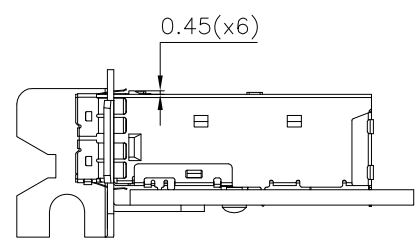

ASSEMBLED VIEW

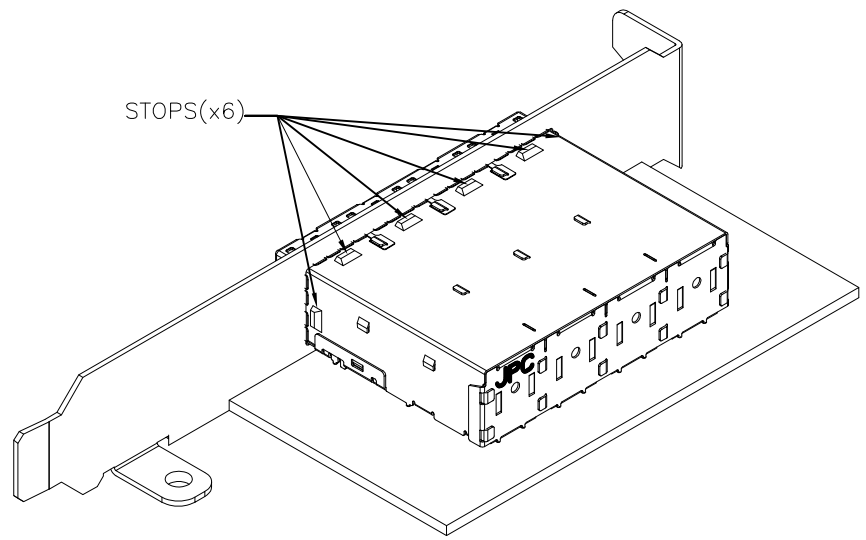

<b>ROHS COMPLIANT</b>	<b>HALOGEN FREE</b>	Unit : mm	PROJECTION		<b>JESS-LINK PRODUCTS CO.,LTD.</b>		TITLE SFF 8644 EXTERNAL HD COMBO TYPE CONNECTOR(STANDARD W/STOPS 1X4 PORT)	PRODUCT NO. OR LAYOUT	
		GENERAL TOLERANCES: (UNLESS SPECIFIED)		D.R. 08/28/2012					James
		0 = ±.45		CH.K 08/28/2012	James	SCALE	SIZE	PART NO.	REV. 04
		0.0 = ±.30		APV.D 08/28/2012	Matsu	1:1	A4	P9214C03000T-0	SH,T NO.3 OF 11

THIS DRAWING AND THE DATA DISCLOSED HEREIN OR HEREWITH IS NOT TO BE REPRODUCED USED OR DISCLOSED IN WHOLE OR IN PART TO ANYONE WITHOUT THE PERMISSION OF JESS-LINK PRODUCTS CO.,LTD.

CUSTOMER DRAWING

REV.	DESCRIPTION	MDF'D	APP'D	DATE
02	ADD JPC LOGO	Brown	Matsu	02/17/2014
03	ADD RECOMMENDED PRINTED CIRCUIT BOARD	Brown	Matsu	03/24/2014
04	MODIFY DRAWING	Brown	Matsu	07/01/2015



ALL OTHER M/B APPLICATIONS

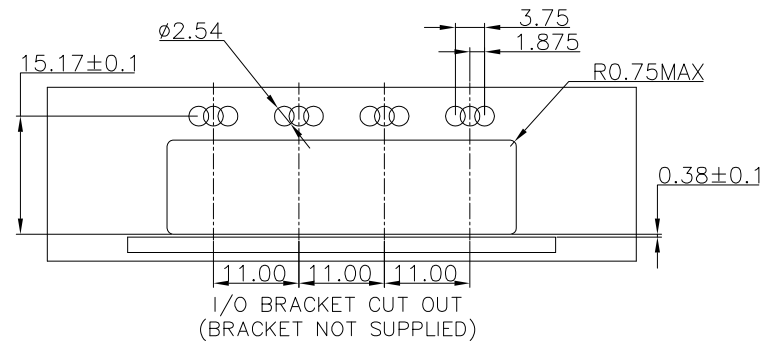
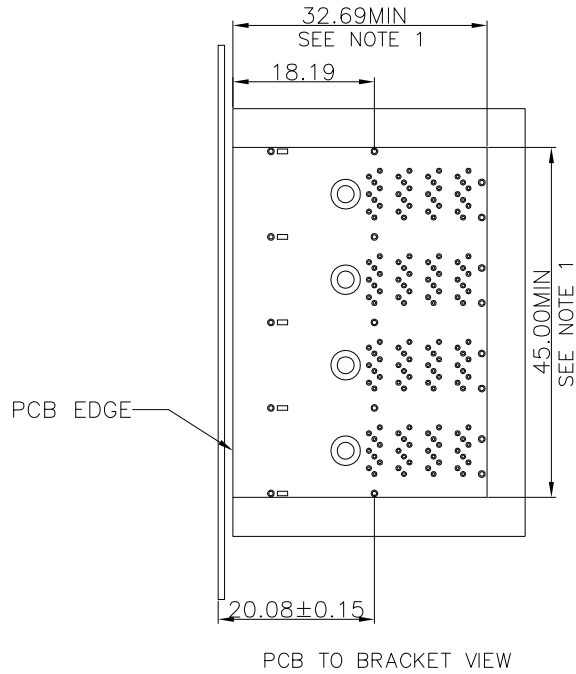
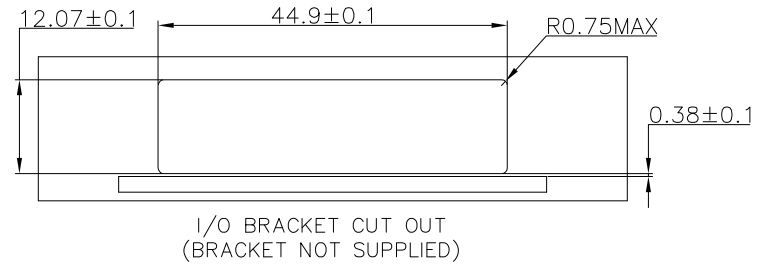
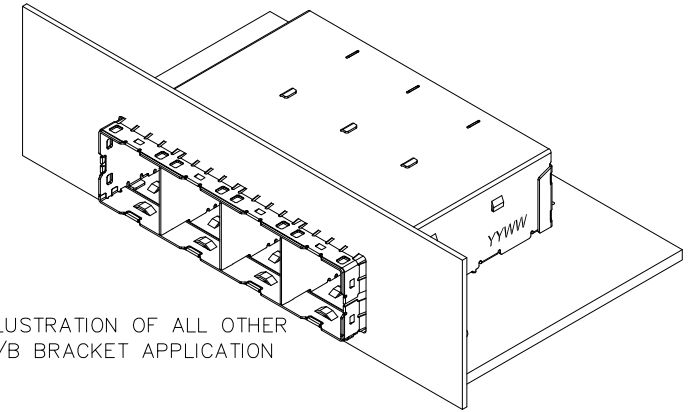
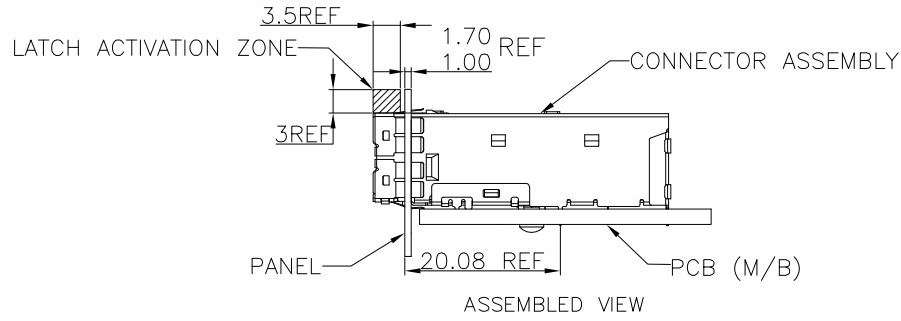

NOTE:  
1. CONNECTOR KEEP OUT AREA

<b>ROHS COMPLIANT</b>	<b>HALOGEN FREE</b>	Unit : mm	PROJECTION		<b>JESS-LINK PRODUCTS CO.,LTD.</b>		TITLE SFF 8644 EXTERNAL HD COMBO TYPE CONNECTOR(STANDARD W/STOPS 1X4 PORT)	PRODUCT NO. OR LAYOUT	
		GENERAL TOLERANCES: (UNLESS SPECIFIED)							
		0 = ±.45 0.0 = ±.30 0.00 = ±.20 0.000 = ±.10 0° = ± 2° 0.0° = ± 1°	D.R. 08/28/2012 Brown	James	APV.D 08/28/2012 Matsu	SCALE 1:1	SIZE A4	PART NO. P9214C03000T-0	REV. 04
		SH,T NO.4 OF 11							



THIS DRAWING AND THE DATA DISCLOSED HEREIN OR HEREWITH IS NOT TO BE REPRODUCED USED OR DISCLOSED IN WHOLE OR IN PART TO ANYONE WITHOUT THE PERMISSION OF JESS-LINK PRODUCTS CO.,LTD.

CUSTOMER DRAWING

REV.	DESCRIPTION	MDF'D	APP'D	DATE
02	ADD JPC LOGO	Brown	Matsu	02/17/2014
03	ADD RECOMMENDED PRINTED CIRCUIT BOARD	Brown	Matsu	03/24/2014
04	MODIFY DRAWING	Brown	Matsu	07/01/2015



RECOMMENDED FOOTPRINT  
(FOR SINGLE PORT LIGHT PIPE)

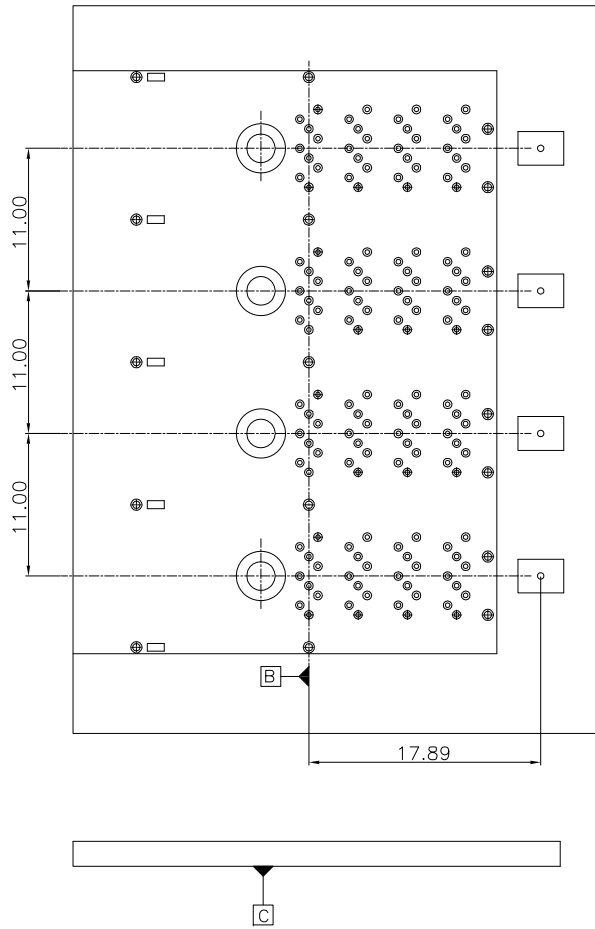

RECOMMENDED FOOTPRINT  
(FOR DUAL PORT LIGHT PIPE)

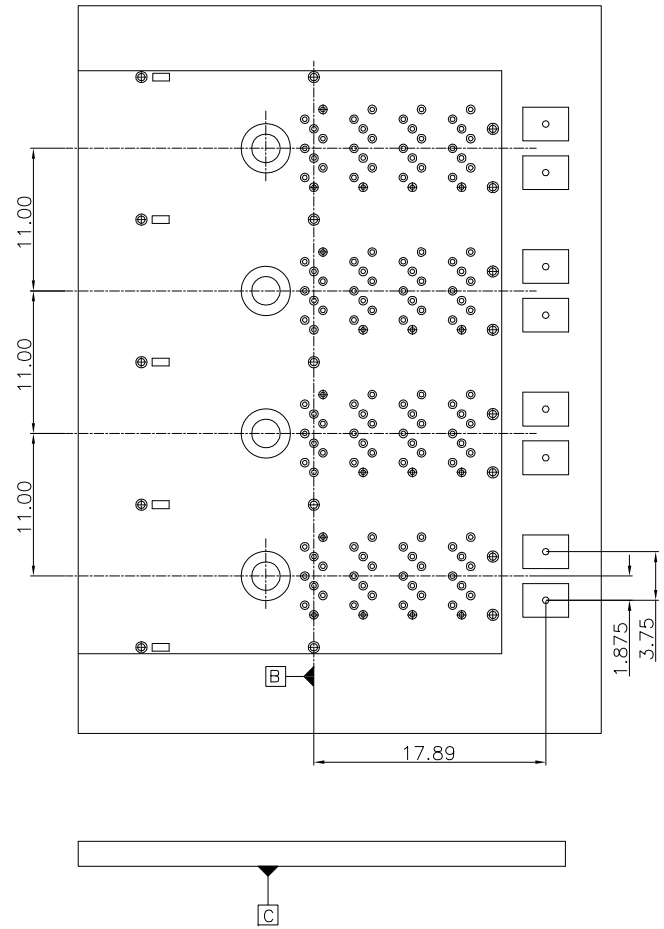

<b>ROHS COMPLIANT</b>	<b>HALOGEN FREE</b>	Unit : mm	PROJECTION	<b>JESS-LINK PRODUCTS CO.,LTD.</b>		PRODUCT NO. OR LAYOUT
		GENERAL TOLERANCES: (UNLESS SPECIFIED)				
		0 = ±.45	D.R. 08/28/2012	TITLE SFF 8644 EXTERNAL HD COMBO TYPE	PART NO.	REV. 04
		0.0 = ±.30	Brown 08/28/2012	CONNECTOR(STANDARD W/STOPS 1X4 PORT)		
0.00 = ±.20	CH.K 08/28/2012	SCALE	SIZE			
0.000 = ±.10	James	1:2	A4			
0° = ± 2°	APV.D 08/28/2012					
0.0° = ± 1°	Matsu					

THIS DRAWING AND THE DATA DISCLOSED HEREIN OR HEREWITH IS NOT TO BE REPRODUCED USED OR DISCLOSED IN WHOLE OR IN PART TO ANYONE WITHOUT THE PERMISSION OF JESS-LINK PRODUCTS CO.,LTD.

CUSTOMER DRAWING

REV.	DESCRIPTION	MDF'D	APP'D	DATE
02	ADD JPC LOGO	Brown	Matsu	02/17/2014
03	ADD RECOMMENDED PRINTED CIRCUIT BOARD	Brown	Matsu	03/24/2014
04	MODIFY DRAWING	Brown	Matsu	07/01/2015



RECOMMENDED TOLLING KEEP OUT AREAS

RECOMMENDED INSERTION TOLL  
KPP OUT AREA  
NO COMPONENTS IN THIS AREA  
MORE THAN 7.50mm TALL

RECOMMENDED INSERTION TOLL  
KPP OUT AREA  
NO COMPONENTS IN THIS AREA

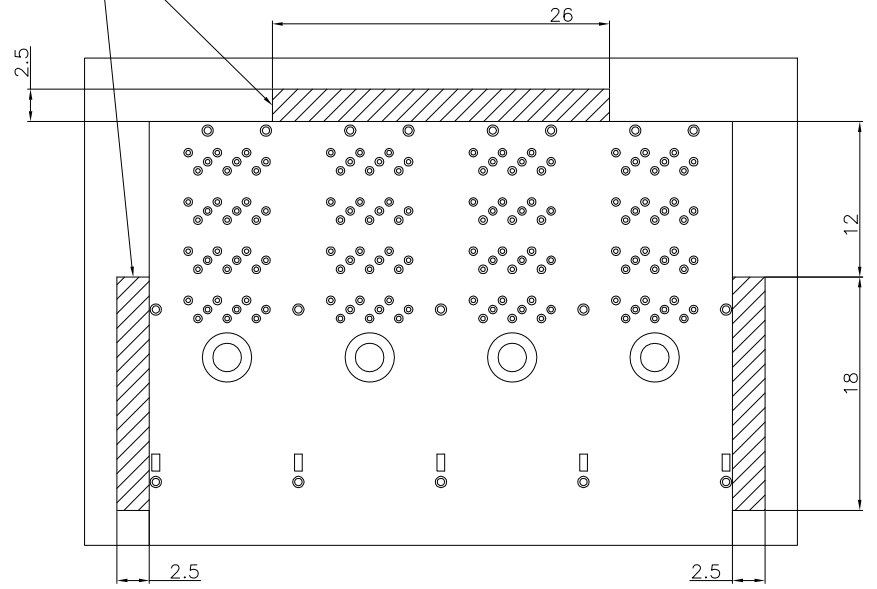
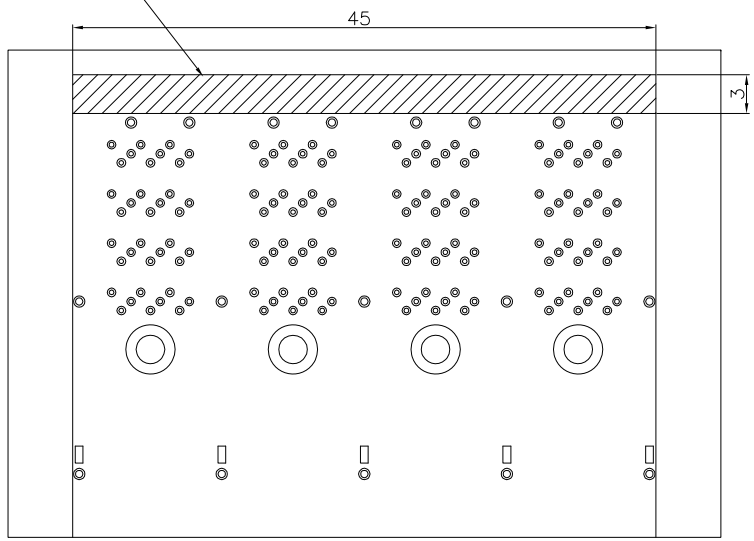

<b>ROHS COMPLIANT</b>	<b>HALOGEN FREE</b>	Unit : mm	PROJECTION		<b>JESS-LINK PRODUCTS CO.,LTD.</b>		PRODUCT NO. OR LAYOUT
		GENERAL TOLERANCES: (UNLESS SPECIFIED)					
		0 = ±.45	D.R. 08/28/2012	TITLE	8644 EXTERNAL HD COMBO TYPE CONNECTOR(STANDARD W/STOPS 1X4 PORT)	REV. 04	
		0.0 = ±.30	Brown 08/28/2012	SCALE			
0.00 = ±.20	CH.K 08/28/2012	SIZE	PART NO.	SH.T NO.7 OF 11			
0.000 = ±.10	James	1:2	P9214C03000T-0				
0° = ± 2°	APV.D 08/28/2012	Matsu					
0.0° = ± 1°							

THIS DRAWING AND THE DATA DISCLOSED HEREIN OR HEREWITH IS NOT TO BE REPRODUCED USED OR DISCLOSED IN WHOLE OR IN PART TO ANYONE WITHOUT THE PERMISSION OF JESS-LINK PRODUCTS CO.,LTD.

CUSTOMER DRAWING

REV.	DESCRIPTION	MDF'D	APP'D	DATE
02	ADD JPC LOGO	Brown	Matsu	02/17/2014
03	ADD RECOMMENDED PRINTED CIRCUIT BOARD	Brown	Matsu	03/24/2014
04	MODIFY DRAWING	Brown	Matsu	07/01/2015



RECOMMENDED TOLLING KEEP OUT AREAS  
( FOR LIGHT PIPE)

RECOMMENDED INSERTION TOLL  
KPP OUT AREA  
NO COMPONENTS IN THIS AREA  
MORE THAN 7.50mm TALL

RECOMMENDED INSERTION TOLL  
KPP OUT AREA  
NO COMPONENTS IN THIS AREA

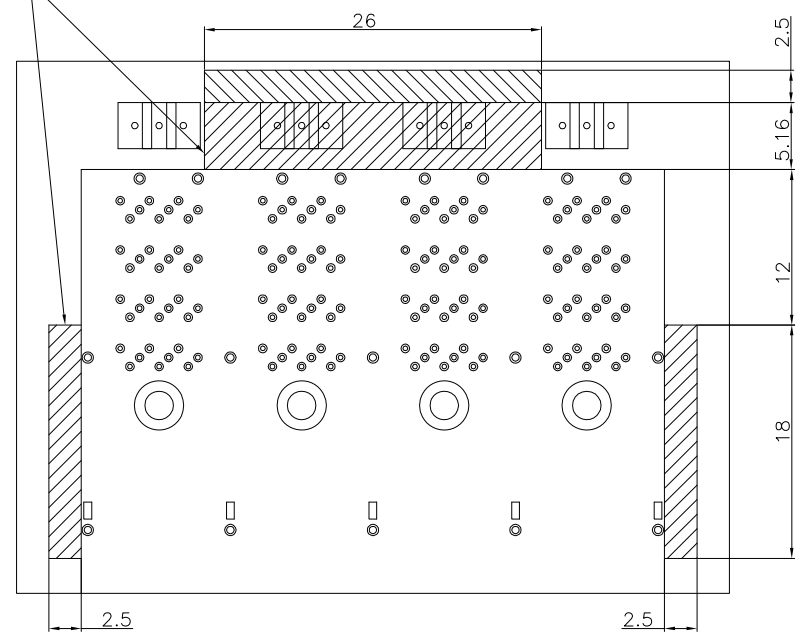
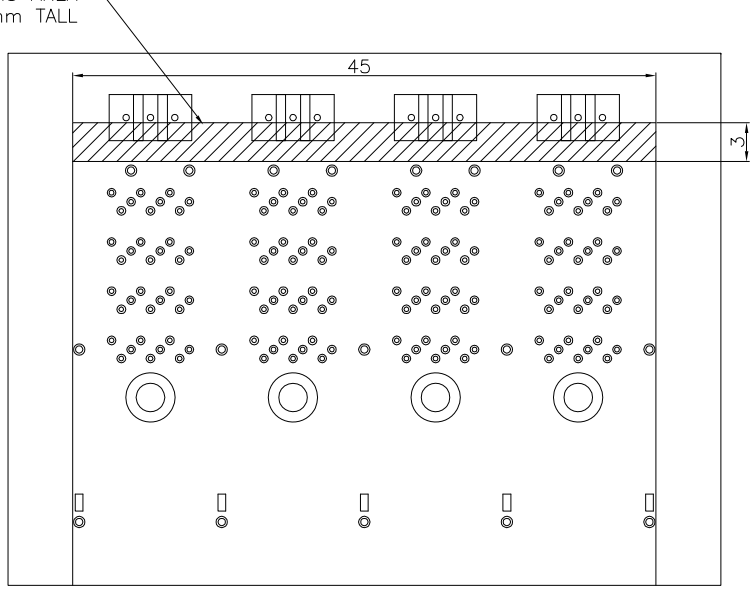

<b>ROHS COMPLIANT</b>	<b>HALOGEN FREE</b>	Unit : mm	PROJECTION		<b>JESS-LINK PRODUCTS CO.,LTD.</b>		PRODUCT NO. OR LAYOUT
		GENERAL TOLERANCES: (UNLESS SPECIFIED)					
		0 = ±.45	D.R. 08/28/2012	TITLE	SFF 8644 EXTERNAL HD COMBO TYPE CONNECTOR(STANDARD W/STOPS 1X4 PORT)		
		0.0 = ±.30	Brown 08/28/2012	CH.K			
0.00 = ±.20	James 08/28/2012	APV.D	SCALE	SIZE	PART NO.	REV. 04	
0.000 = ±.10	Matsu 08/28/2012	1:2	A4	P9214C03000T-0	SH,T NO.8 OF 11		
0° = ± 2'							
0.0° = ± 1'							



THIS DRAWING AND THE DATA DISCLOSED HEREIN OR HEREWITH IS NOT TO BE REPRODUCED USED OR DISCLOSED IN WHOLE OR IN PART TO ANYONE WITHOUT THE PERMISSION OF JESS-LINK PRODUCTS CO.,LTD.

CUSTOMER DRAWING

REV.	DESCRIPTION	MDF'D	APP'D	DATE
02	ADD JPC LOGO	Brown	Matsu	02/17/2014
03	ADD RECOMMENDED PRINTED CIRCUIT BOARD	Brown	Matsu	03/24/2014
04	MODIFY DRAWING	Brown	Matsu	07/01/2015



PIN OUT DESIGNATIONS

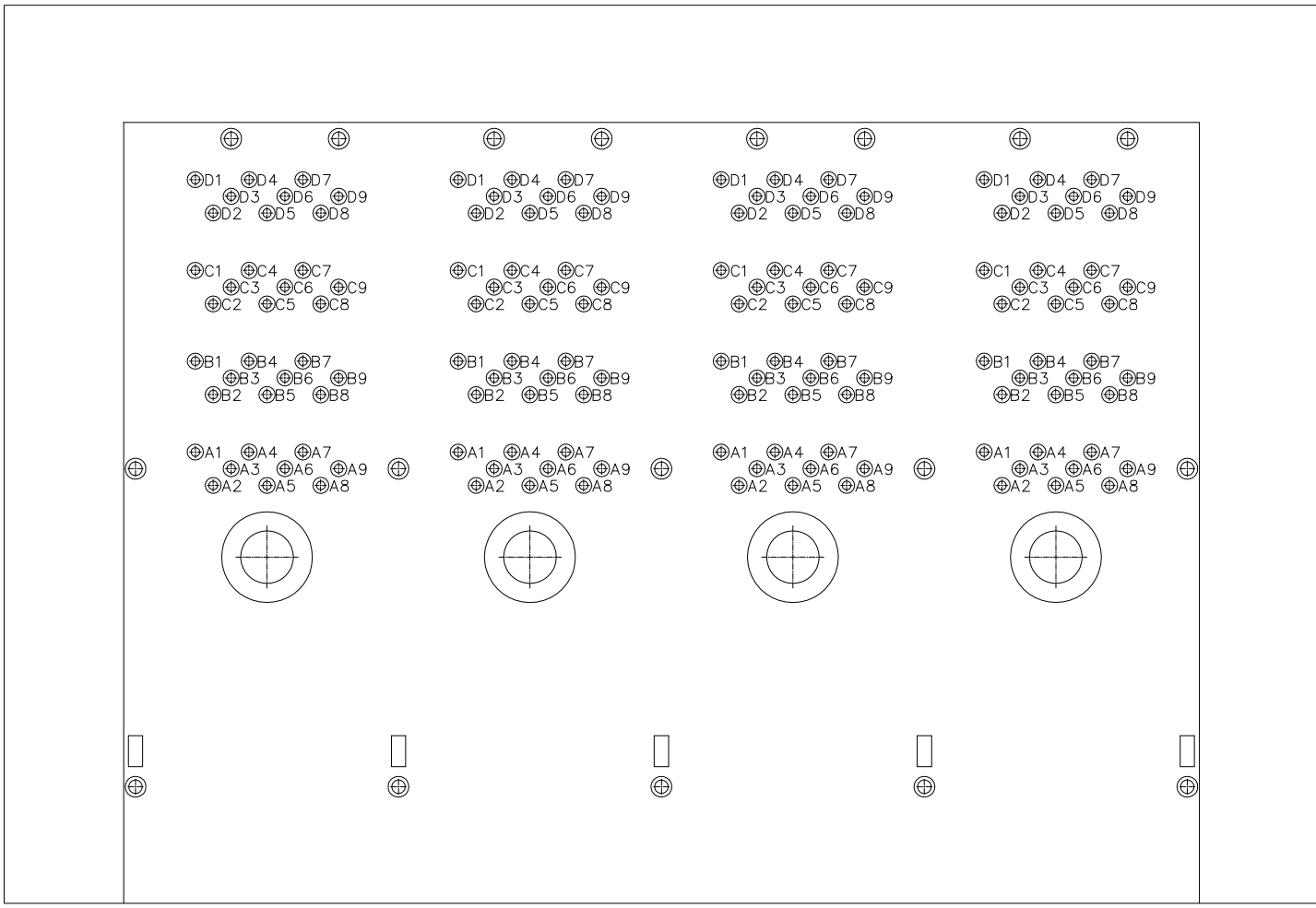

<b>ROHS COMPLIANT</b>	<b>HALOGEN FREE</b>	Unit : mm	PROJECTION	<b>JESS-LINK PRODUCTS CO.,LTD.</b>		TITLE 8644 EXTERNAL HD COMBO TYPE CONNECTOR(STANDARD W/STOPS 1X4 PORT)	PRODUCT NO. OR LAYOUT
		GENERAL TOLERANCES: (UNLESS SPECIFIED)					
		0 = ±.45	D.R. 08/28/2012	SCALE 1:2	SIZE A4	PART NO. P9214C03000T-0	REV. 04
		0.0 = ±.30	Brown 08/28/2012				
0.00 = ±.20	CH.K 08/28/2012	James					
0.000 = ±.10	APV.D 08/28/2012	Matsu					
0° = ± 2'							
0.0° = ± 1'							

THIS DRAWING AND THE DATA DISCLOSED HEREIN OR HEREWITH IS NOT TO BE REPRODUCED USED OR DISCLOSED IN WHOLE OR IN PART TO ANYONE WITHOUT THE PERMISSION OF JESS-LINK PRODUCTS CO.,LTD.

CUSTOMER DRAWING

REV.	DESCRIPTION	MDF'D	APP'D	DATE
02	ADD JPC LOGO	Brown	Matsu	02/17/2014
03	ADD RECOMMENDED PRINTED CIRCUIT BOARD	Brown	Matsu	03/24/2014
04	MODIFY DRAWING	Brown	Matsu	07/01/2015

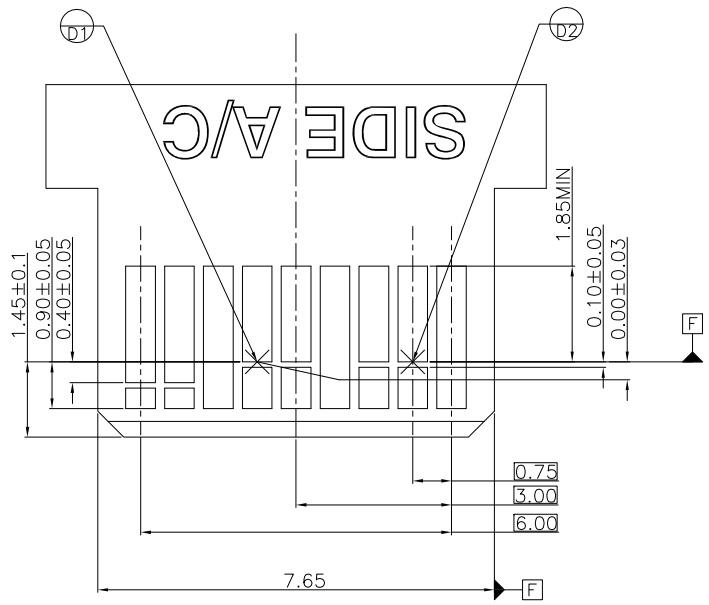
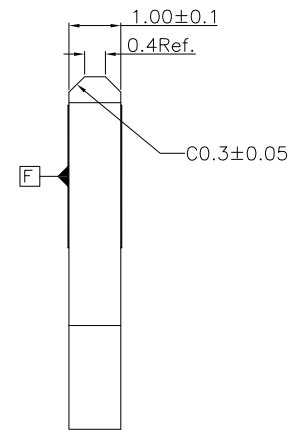
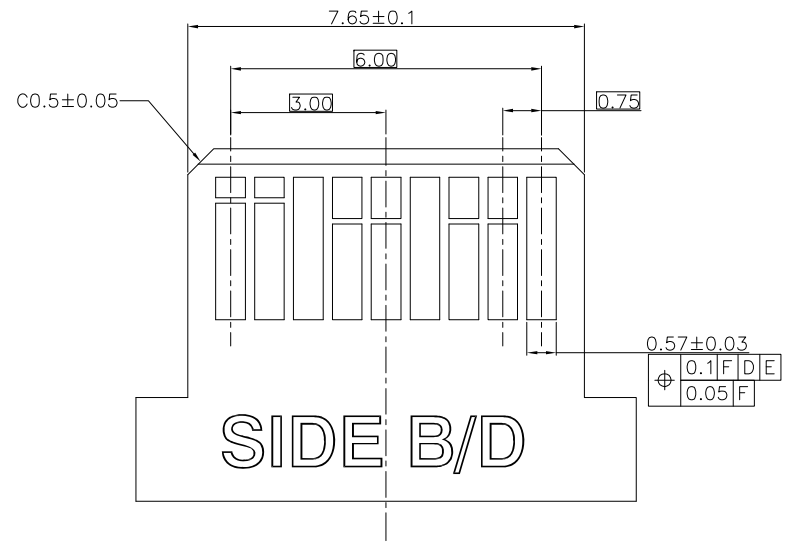

NOTE:  
 1. 0.05 MINIMUM KEEP OUT FOR SOLDER MASK AROUND ALL PADS  
 2. DATUM D TARGETS ARE DEFINED BY THE RESPECTIVE PAD CENTER LINES AND THE LEADING EDGE OF THE TARGET PADS

<b>ROHS COMPLIANT</b>	<b>HALOGEN FREE</b>	Unit : mm	PROJECTION		<b>JESS-LINK PRODUCTS CO.,LTD.</b>		PRODUCT NO. OR LAYOUT
		GENERAL TOLERANCES: (UNLESS SPECIFIED)					
		0 = ±.45 0.0 = ±.30 0.00 = ±.20 0.000 = ±.10 0" = ±.2" 0.0" = ±.1"	D.R. 08/28/2012 Brown	TITLE 8644 EXTERNAL HD COMBO TYPE CONNECTOR(STANDARD W/STOPS 1X4 PORT)		REV. 04	
			CH.K 08/28/2012 James	SCALE 1:2	SIZE A4	PART NO. P9214C03000T-0	SH,T NO.10 OF 11
	APV.D 08/28/2012 Matsu						

THIS DRAWING AND THE DATA DISCLOSED HEREIN OR HEREWITH IS NOT TO BE REPRODUCED USED OR DISCLOSED IN WHOLE OR IN PART TO ANYONE WITHOUT THE PERMISSION OF JESS-LINK PRODUCTS CO.,LTD.

CUSTOMER DRAWING

REV.	DESCRIPTION	MDF'D	APP'D	DATE
02	ADD JPC LOGO	Brown	Matsu	02/17/2014
03	ADD RECOMMENDED PRINTED CIRCUIT BOARD	Brown	Matsu	03/24/2014
04	MODIFY DRAWING	Brown	Matsu	07/01/2015

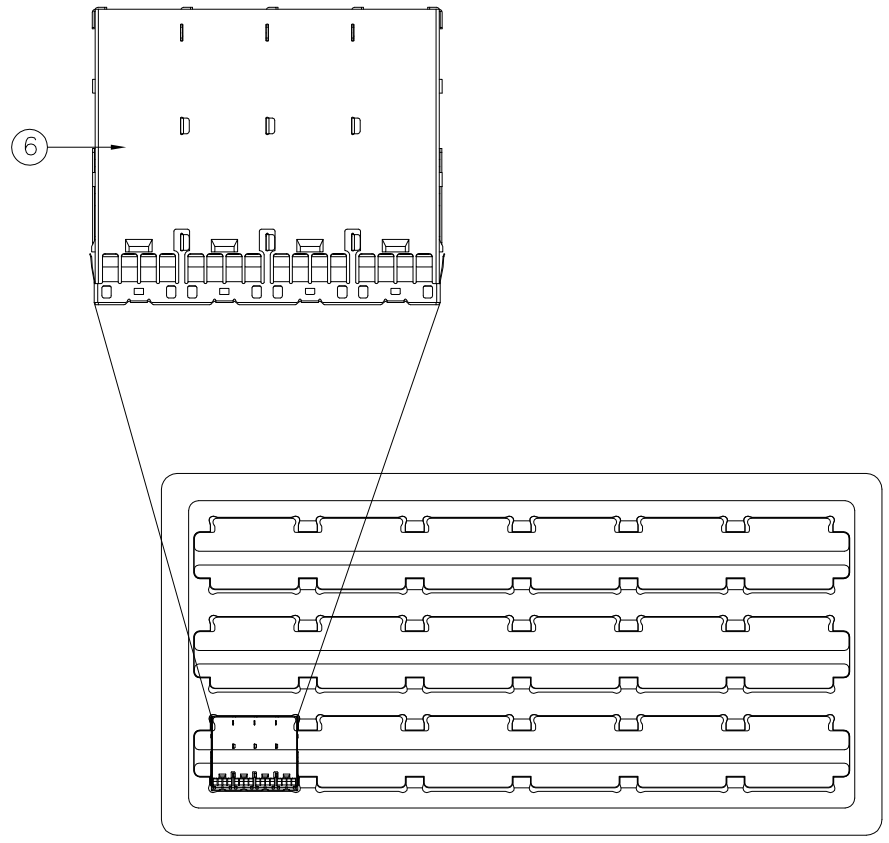
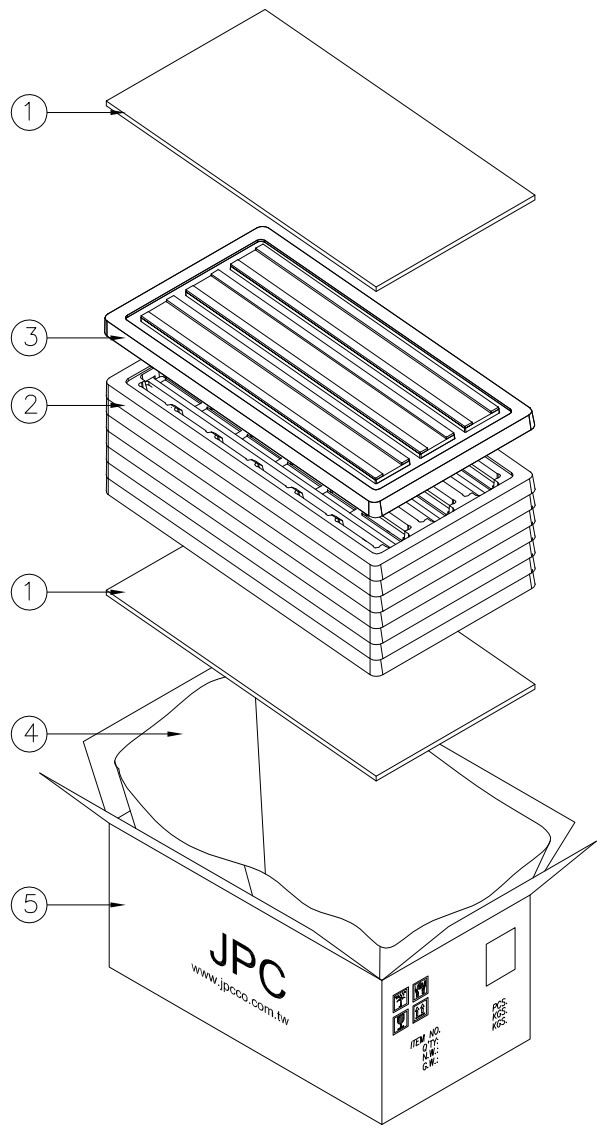

ITEM	DESCRIPTION	Q'TY
7		
6	CONNECTOR	144
5	MASTER CARTON, 405X220X185 mm	1
4	WATERROOF BAG, 400X(107.5+107.5)X415 mm	1
3	TOP TRAY, PET, 370X196X17.8 mm (18Pcs. / Tray)	9
2	BOTTOM TRAY, PET, 370X196X17.8 mm (18Pcs. / Tray)	8
1	PAPER PAD, 385X200X3mm	2

<b>ROHS COMPLIANT</b> <b>HALOGEN FREE</b>	Unit : mm	PROJECTION				<b>JESS-LINK PRODUCTS CO.,LTD.</b>	
	GENERAL TOLERANCES: (UNLESS SPECIFIED)	D.R. Brown 08/28/2012	TITLE SFF 8644 EXTERNAL HD COMBO TYPE				
	0 = ±.45 0.0 = ±.30 0.00 = ±.20 0.000 = ±.10 0° = ± 2° 0.0° = ± 1°	CH.K James 08/28/2012	CONNECTOR(STANDARD W/STOPS 1X4 PORT)				
		APV.D Matsu 08/28/2012	SCALE N/A	SIZE A3	PART NO. P9214C03000T-0	REV. 04	
						SH,T NO.11 OF 11	