

Pb
Process Capable

RoHS Compliant

HSF

禁止使用1級環境管理物質

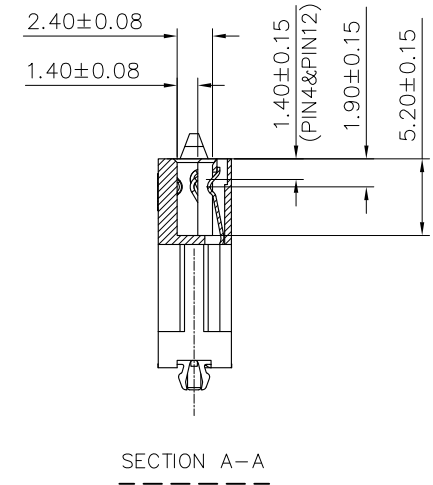
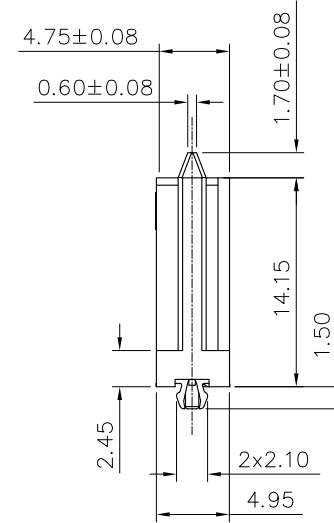
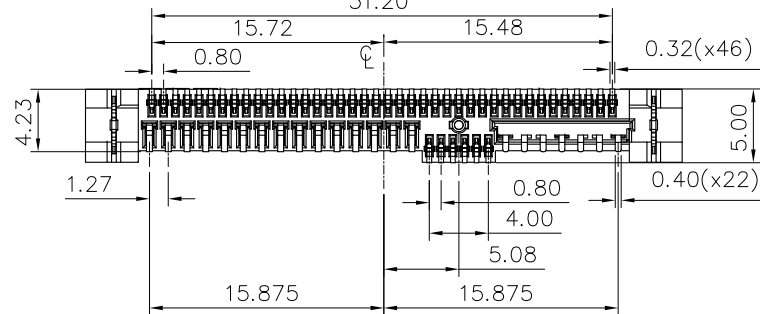
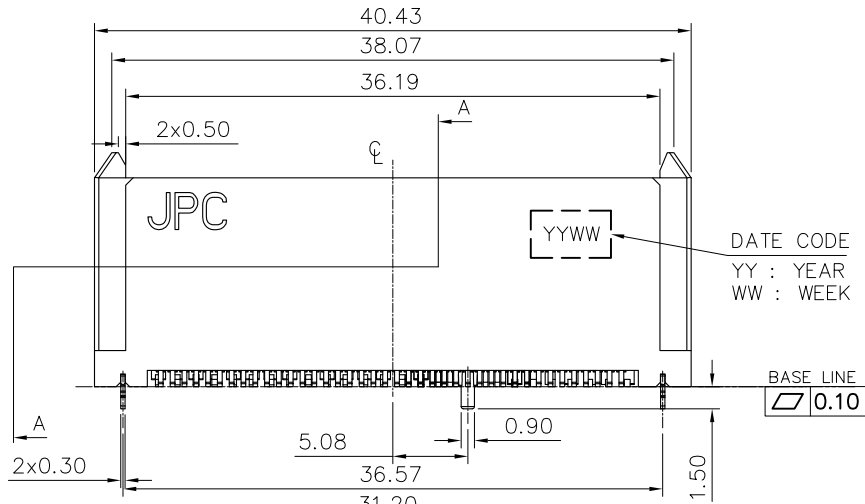
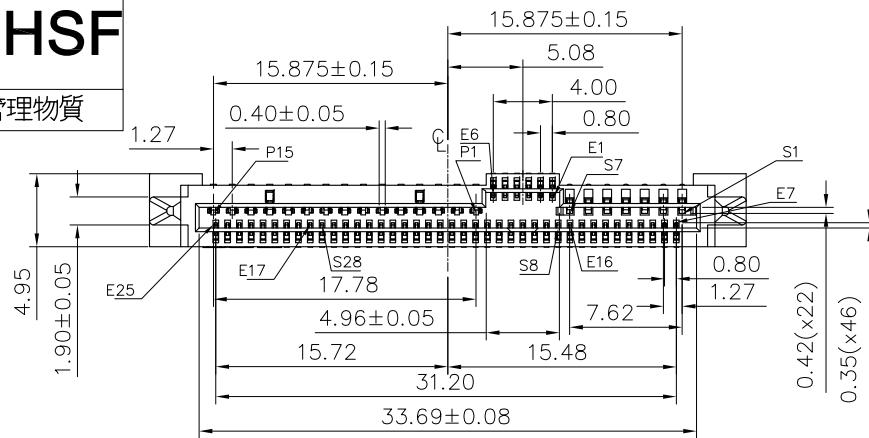

ITEM	DESC.	MATERIAL	REMARKS	PART REMARKS
x = ±0.50	DRAWN		C	TITLE: SFF-8639 SAS HD 68PIN CONNECTOR (CUSTOMER DRAWING)
.xx = ±0.25				
.XX = ±0.15	DESIGN			PART NO. P923B068330T-0
.XXX = ±0.05	CHECKED			PRODUCT NO. C14N0177A
XX' = ±1'	APPROVED			DRAWING NO. P923B068330T-0
X.XX' = ±0.5'	TOLERANCES			UNIT: mm SCALE: 2:1 REV: 01 SHT: 1of2

JESS - LINK PRODUCTS CO., LTD.

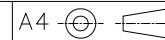

ECN NO.	REV	DATE	DESCRIPTION	MDF'D	APP'D
	01	08/06-14"	NEW DRAWING RELEASE	ZHAO	RICHARD

THIS DRAWING CONTAINS INFORMATION THAT IS PROPRIETARY TO JPC INCORPORATED AND SHOULD NOT BE USED WITHOUT WRITTEN REMISSION.

D

D

C

B

A

A

8 7 6 5 4 3 2 1

8 7 6 5 4 3 2 1

Pb Process Capable
RoHS Compliant
HSF

禁止使用1級環境管理物質

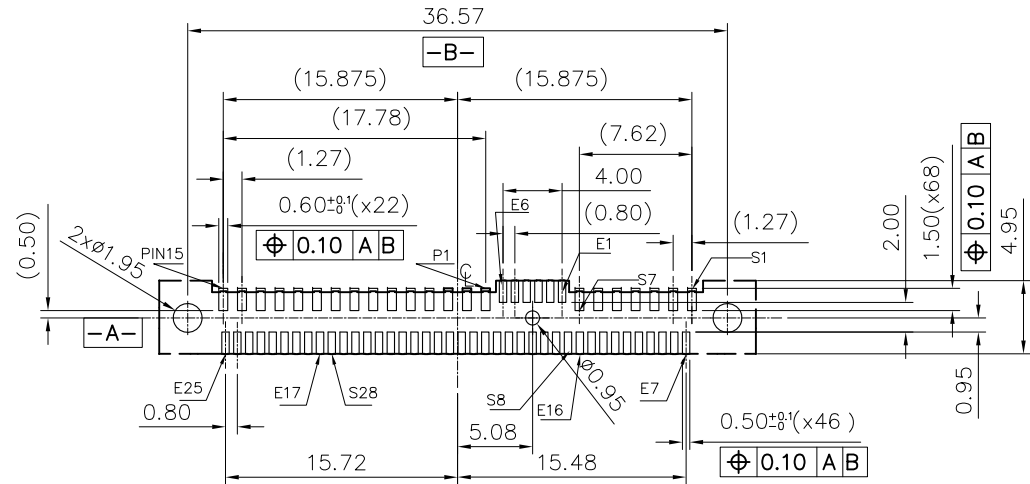

RECOMMEND P.C.B LAYOUT
 T=2.00mm
 GENERAL TOLERANCES: ±0.05

NOTE:

- MATERIAL:
 HOUSING: LCP UL 94V-0 COLOR: BLACK
 TERMINAL/FORKLOCK: COPPER ALLOY
- PLATING:
 TERMINAL: 15u" MIN GOLD ON MATING AREA
 100u" MIN MATTE TIN ON SOLDER AREA
 50u" MIN NICKEL UNDERPLATE ALL OVER
 FORKLOCK: 50u" MIN NICKEL UNDERPLATE ALL OVER
 100u" MIN MATTE TIN ALL OVER
- PACKAGE: TRAY

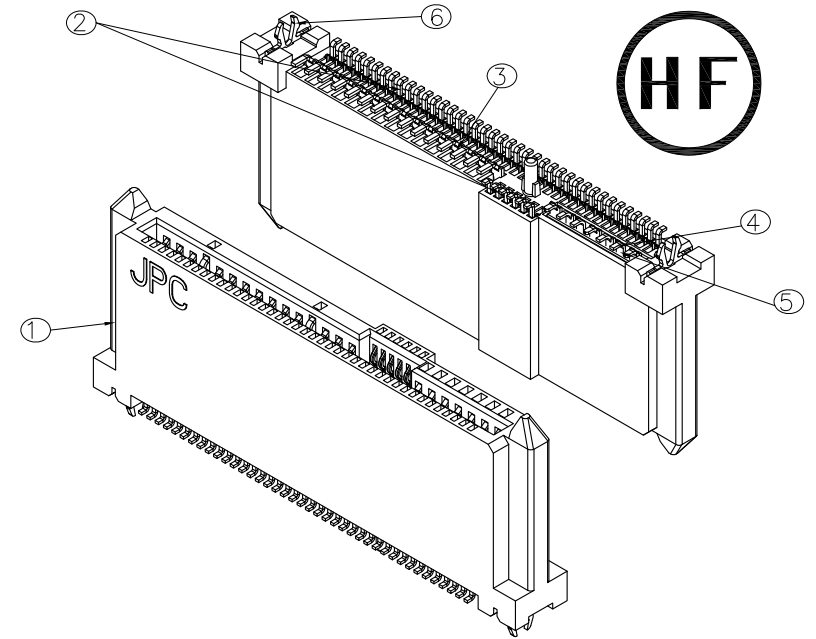

CAP 組裝示意圖

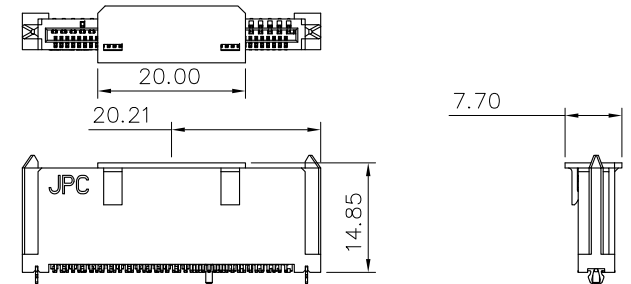

6	FORK	COPPER ALLOY		
5	HOUSING	LCP		
4	TERMINAL	COPPER ALLOY		
3	TERMINAL	COPPER ALLOY		
2	TERMINAL	COPPER ALLOY		
1	HOUSING	LCP		
ITEM	DESC.	MATERIAL	REMARKS	PART REMARKS
	DRAWN		C TITLE: SFF-8639 SAS HD 68PIN CONNECTOR — (CUSTOMER DRAWING)	
	DESIGN			PART NO. P923B068330T-0
	CHECKED			PRODUCT NO. C14N0177A
	APPROVED			DRAWING NO. P923B068330T-0
TOLERANCES				
UNIT: mm SCALE: 2:1 REV: 01 SHT: 2of2				

JESS - LINK PRODUCTS CO., LTD.

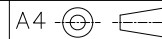

ECN NO.	01	08/06-14"	NEW DRAWING RELEASE	ZHAO	RICHARD
REV			DESCRIPTION	MDF'D	APP'D

THIS DRAWING CONTAINS INFORMATION THAT IS PROPRIETARY TO JPC INCORPORATED AND SHOULD NOT BE USED WITHOUT WRITTEN REMISSION.