

THIS DRAWING AND THE DATA DISCLOSED HEREIN OR HEREWITH IS NOT TO BE REPRODUCED USED OR DISCLOSED IN WHOLE OR IN PART TO ANYONE WITHOUT THE PERMISSION OF JESS-LINK PRODUCTS CO.,LTD.

CUSTOMER DRAWING

REV.	DESCRIPTION	MDF'D	APP'D	DATE
03	ADD TOLERANCES	Brown	Matsu	04/21/2015
04	MODIFY PCB LAYOUT	Brown	Matsu	10/23/2015
05	ADD PCB DIM	Jason	Ray	11/14/2017

NOTE:

- MATERIAL:
HOUSING: HI-TEMP THERMOPLASTIC UL 94V-0 BLACK
TERMINAL/FORKLOCK:COPPER ALLOY
- PLATING:
TERMINAL:30u" MIN GOLD ON MATING AREA
100u" MIN MATTE TIN ON SOLDER AREA
50u" MIN NICKEL UNDERPLATE ALL OVER
FORKLOCK:50u" MIN NICKEL UNDERPLATE ALL OVER
100u" MIN MATTE TIN ALL OVER
- DATE CODE: YYWW
YY=YEAR OF MANUFACTURE
WW=WEEK OF MANUFACTURE
- PACKAGE:TAPE & REEL

JPC P/N:P 9 2 3 B 0 6 8 3 F 0 R-0

SFF 8639 RECEPTACLE
R/A SMT H=2.85mm

POS:
062: 62PIN
068: 68PIN

CONNECTOR PLATING:
2:MATING -15U" Au/TAIL MATT TIN
3:MATING -30U" Au/TAIL MATT TIN

PACKAGE R: TAPE & REEL
0: FORK=3.12mm
F: FORK

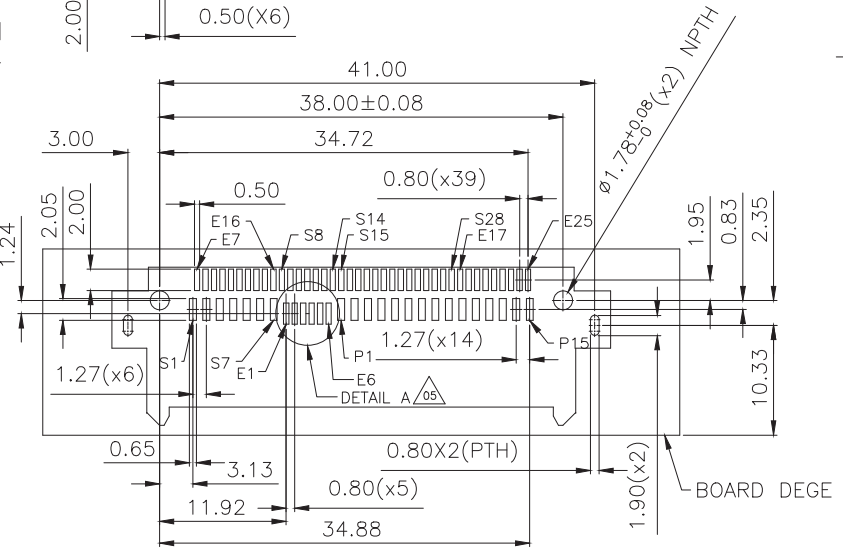
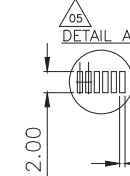
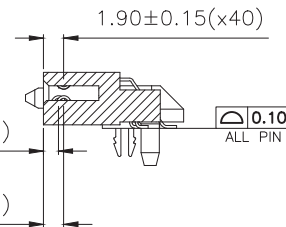
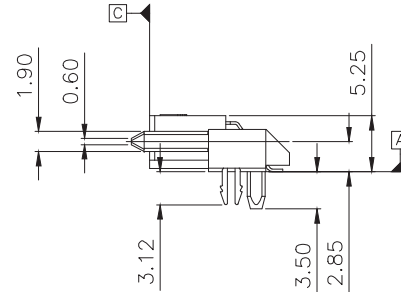
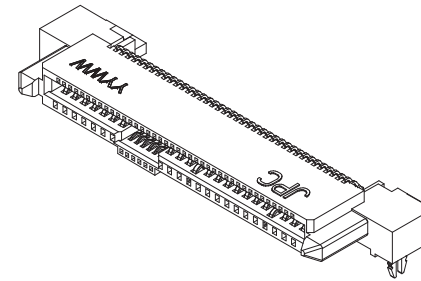

RECOMMENDED PCB LAYOUT
(PCB THICKNESS: 1.60mm)

ROHS COMPLIANT	HALOGEN FREE	Unit : mm	PROJECTION		JESS-LINK PRODUCTS CO.,LTD.		TITLE SAS/PCIe 68PIN CONNECTOR (RECEPTACLE,R/A SMT H=2.85mm)	PRODUCT NO. OR LAYOUT
		GENERAL TOLERANCES: (UNLESS SPECIFIED)	D.R. 03/07/2014					
		0 = ±.45 0.0 = ±.30 0.00 = ±.20 0.000 = ±.10 0' = ±.2' 0.0' = ±.1'	Brown	James	SCALE	SIZE	PART NO.	REV. 05
		APV.D 03/07/2014	Matsu	1:2	A3	P923B0683FOR-0	SH.T NO.1 OF 2	

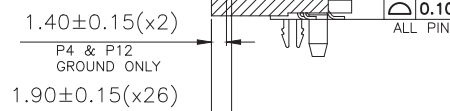
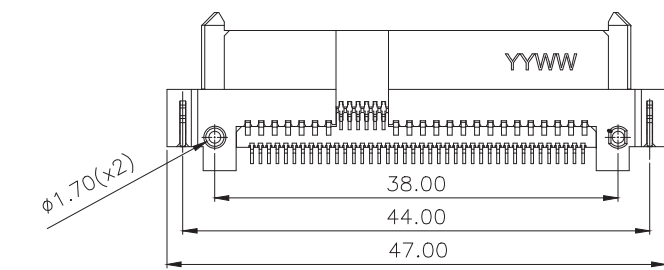
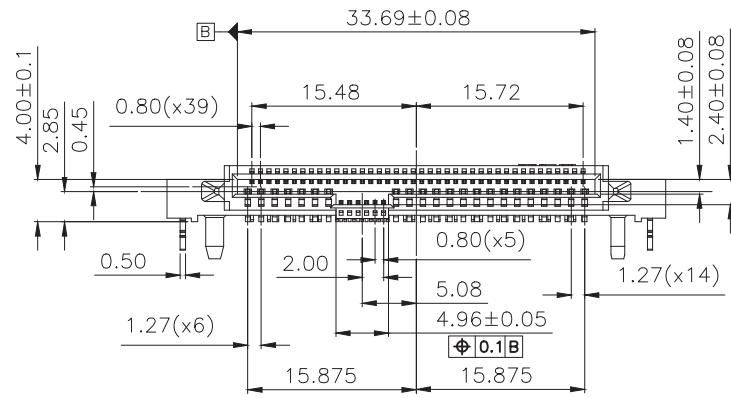
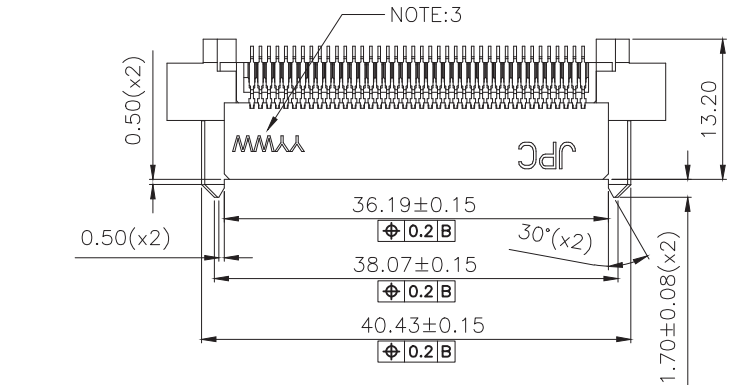
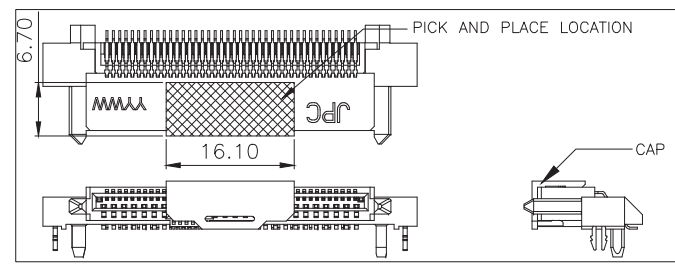

A
B
C
D
E
F

A
B
C
D
E
F

1 2 3 4 5 6 7 8

THIS DRAWING AND THE DATA DISCLOSED HEREIN OR HEREWITH IS NOT TO BE REPRODUCED USED OR DISCLOSED IN WHOLE OR IN PART TO ANYONE WITHOUT THE PERMISSION OF JESS-LINK PRODUCTS CO.,LTD.

CUSTOMER DRAWING

REV.	DESCRIPTION	MDF'D	APP'D	DATE
03	ADD TOLERANCES	Brown	Matsu	04/21/2015
04	MODIFY PCB LAYOUT	Brown	Matsu	10/23/2015
05	ADD PCB DIM	Jason	Ray	11/14/2017

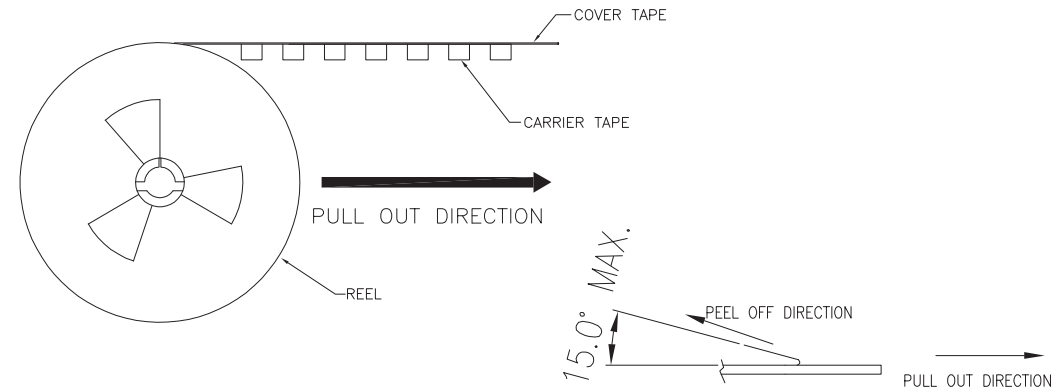
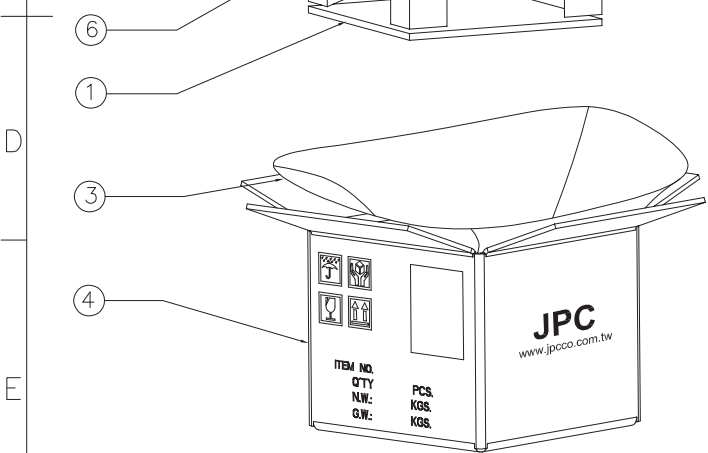
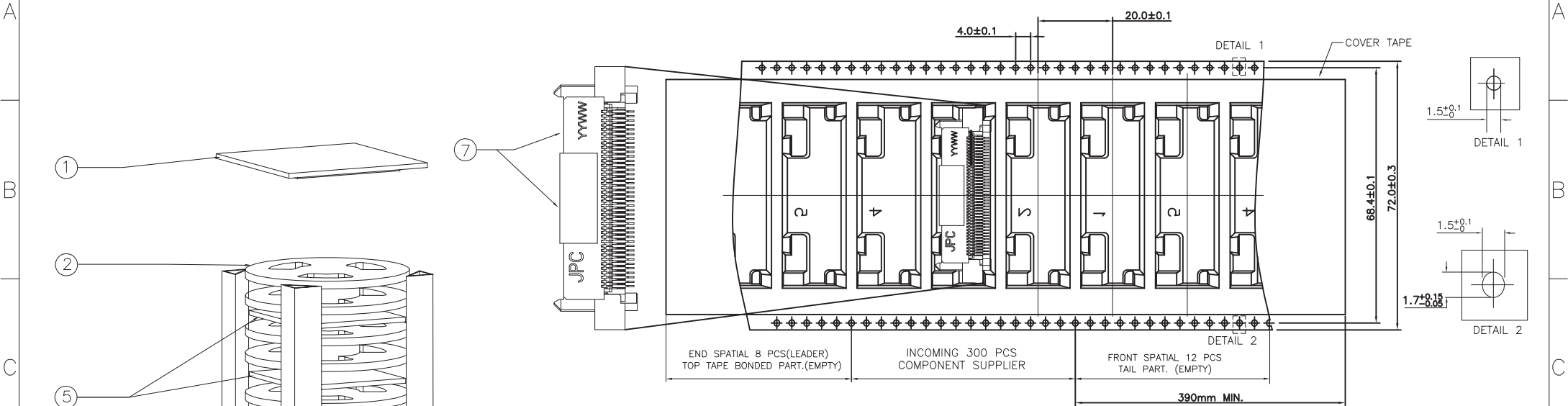

NOTE:
 1. PEELING OFF FORCE OF THE TOPTAPE:20-150gf.
 2. TAPE AND REEL QUANTITY: 300PCS/REEL.

ITEM	DESCRIPTION	QTY
9		
8		
7	SAS/PCIe 68PIN FEMALE CONNECTOR & PICK-UP CAP 300PCS/REEL	900
6	EDGE BOARD, 370X125X5mm	4
5	BUBBLE BAG, 325X325X5mm	2
4	MASTER CARTON, 332X332X260mm	1
3	WATERPROOF PE BAG, 500X(175+175)X600mm	1
2	TAPE & REEL 13" CARRIER TAPE W=72mm & REEL Ø330x72.4mm	3
1	PAPER PAD, 325X325X5mm	2

RoHS COMPLIANT	HALOGEN FREE	Unit : mm	PROJECTION		JESS-LINK PRODUCTS CO.,LTD.	PRODUCT NO. OR LAYOUT
		GENERAL TOLERANCES: (UNLESS SPECIFIED)		TITLE		
		0 = ±.45	D.R. Brown 03/07/2014	SAS/PCIe 68PIN CONNECTOR		
		0.0 = ±.30	CH.K James 03/07/2014	(RECEPTACLE,R/A SMT H=2.85mm)		
0.00 = ±.20	APV.D Matsu 03/07/2014	SCALE	SIZE	PART NO.	REV. 05	
0.000 = ±.10		2:1	A3	P923B0683FOR-0	SH.T NO.2 OF 2	
0° = ±.2°						
0.0° = ±.1°						