

THIS DRAWING AND THE DATA DISCLOSED HEREIN OR HEREWITH IS NOT TO BE REPRODUCED USED OR DISCLOSED IN WHOLE OR IN PART TO ANYONE WITHOUT THE PERMISSION OF JESS-LINK PRODUCTS CO.,LTD.

CUSTOMER DRAWING

REV.	DESCRIPTION	MDF'D	APP'D	DATE
01	INITIAL DESIGN	Brown	Matsu	01/30/2015
02	MODIFY DESIGN	Brown	Matsu	03/06/2015
03	MODIFY DESIGN	Brown	Matsu	04/30/2015

NOTE:

- MATERIAL:
HOUSING/CAP: HI-TEMP THERMOPLASTIC UL 94V-0 BLACK
TERMINAL/FORKLOCK: COPPER ALLOY
- PLATING:
TERMINAL: 30u" MIN GOLD ON MATING AREA
100u" MIN MATTE TIN ON SOLDER AREA
50u" MIN NICKEL UNDERPLATE ALL OVER
FORKLOCK: 50u" MIN NICKEL UNDERPLATE OVER
100u" MIN MATTE TIN ALL OVER
- DATE CODE: YYWW
YY=YEAR OF MANUFACTURE
WW=WEEK OF MANUFACTURE
- PACKAGE: TAPE & REEL
- P/N: MARTAX:
JPC P/N: P 9 2 7 B 0 2 9 3 F 1 R - 0

SFF 8680 RECEPTACLE
R/A SMT RESERVE SERIES
(H=5.00mm)

POS:
022: 22PIN
029: 29PIN

PACKAGE
R : TAPE & REEL

1: FORKLOCK TAIL= 2.25mm

CONNECTOR PLATING
2: MATING -15u' Au / TAIL MATT TIN
3: MATING -30u' Au / TAIL MATT TIN

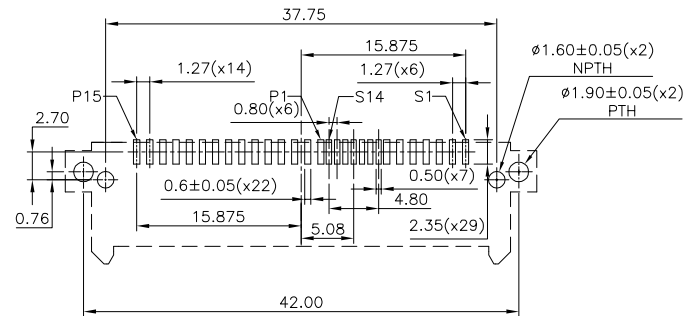
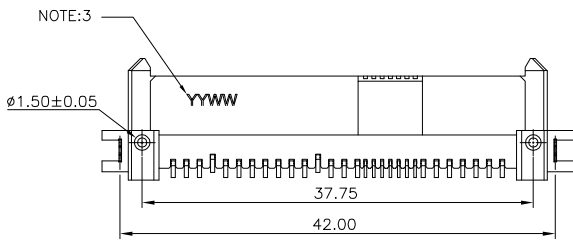
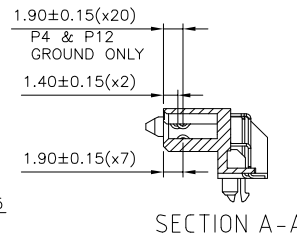
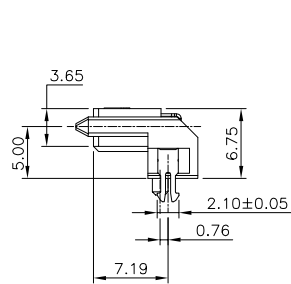
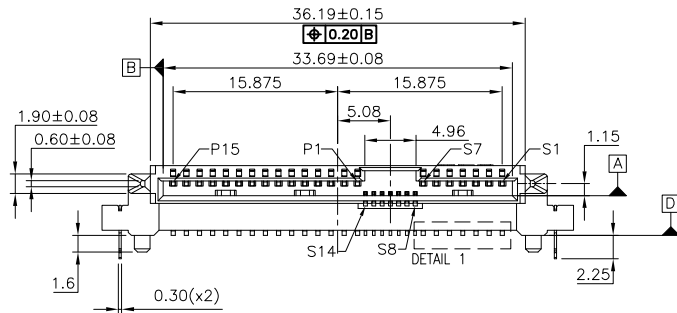
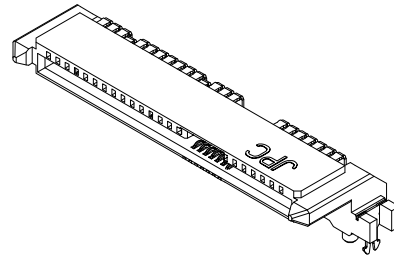
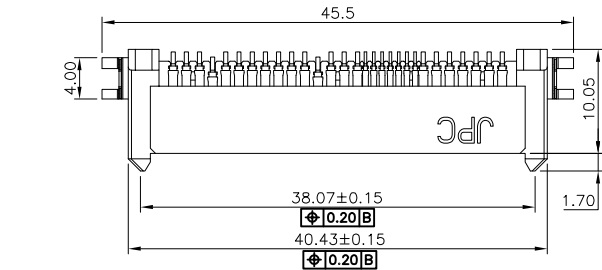

RECOMMENDED PCB LAYOUT

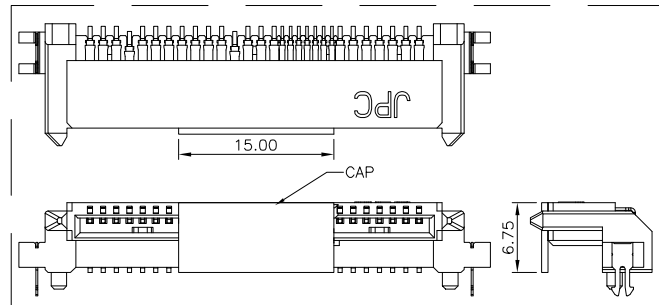
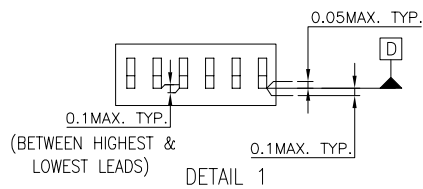

ROHS COMPLIANT	HALOGEN FREE	Unit : mm	PROJECTION	JESS-LINK PRODUCTS CO.,LTD.		D.R. Brown 01/30/2015	TITLE SFF 8680 SAS 29PIN CONNECTOR (Rec.,RESERVE R/A,SMT,H=5.00mm)	PRODUCT NO. OR LAYOUT C15H0304B
		GENERAL TOLERANCES: (UNLESS SPECIFIED)						
		0 = ±.45 0.0 = ±.30 0.00 = ±.20 0.000 = ±.10 0° = ±.2° 0.0° = ±.1°	CH.K James 01/30/2015	SCALE 2:1	SIZE A3	PART NO. P927B0293F1R-0	REV. 03	
			APV.D Matsu 01/30/2015			SH,T NO.1 OF 1		